

RV & CAR/TENT CAMPING

— INFORMATION —

AOPA FLY-IN | MISSOULA INTERNATIONAL AIRPORT | JUNE 15-16, 2018



Thank you for your interest in camping at the AOPA Fly-In at Missoula, MT! We are excited to have you with us. **Camping will only be available Thursday, Friday, and Saturday nights. Arrivals before Thursday will be handled per normal airport operations, and you will be responsible for securing your lodging/transportation off airport property. Please read and be aware of the following:**

[CLICK TO REGISTER FOR CAMPING](#)

RV AND CAR/TENT CAMPING

- All campers must pre-pay and pre-register. Camping position is not assured without reservation.
- Please bring your own food and water! Food is NOT provided on the airfield.
- Ground transportation is NOT provided to get to locations offsite (taxi or rental car reservations must be made on your own).
- Food, water, sunscreen & rain gear recommended.
- Restroom and shower facilities are “primitive.” Porta-potties and handwashing stations will be provided; limited shower facilities may be available, but no guarantee on hot water—there may be lots of campers for just a couple of showers. Please come prepared!
- Camping is open from 12:00 noon Thursday, June 14 until 12:00 noon Sunday, June 17, 2018.

EARLY ARRIVALS

- Camping NOT permitted prior to Thursday, June 14, 2018.
- We will not be able to accommodate you in AOPA attendee parking if you arrive before Thursday, June 14, 12:00 noon.

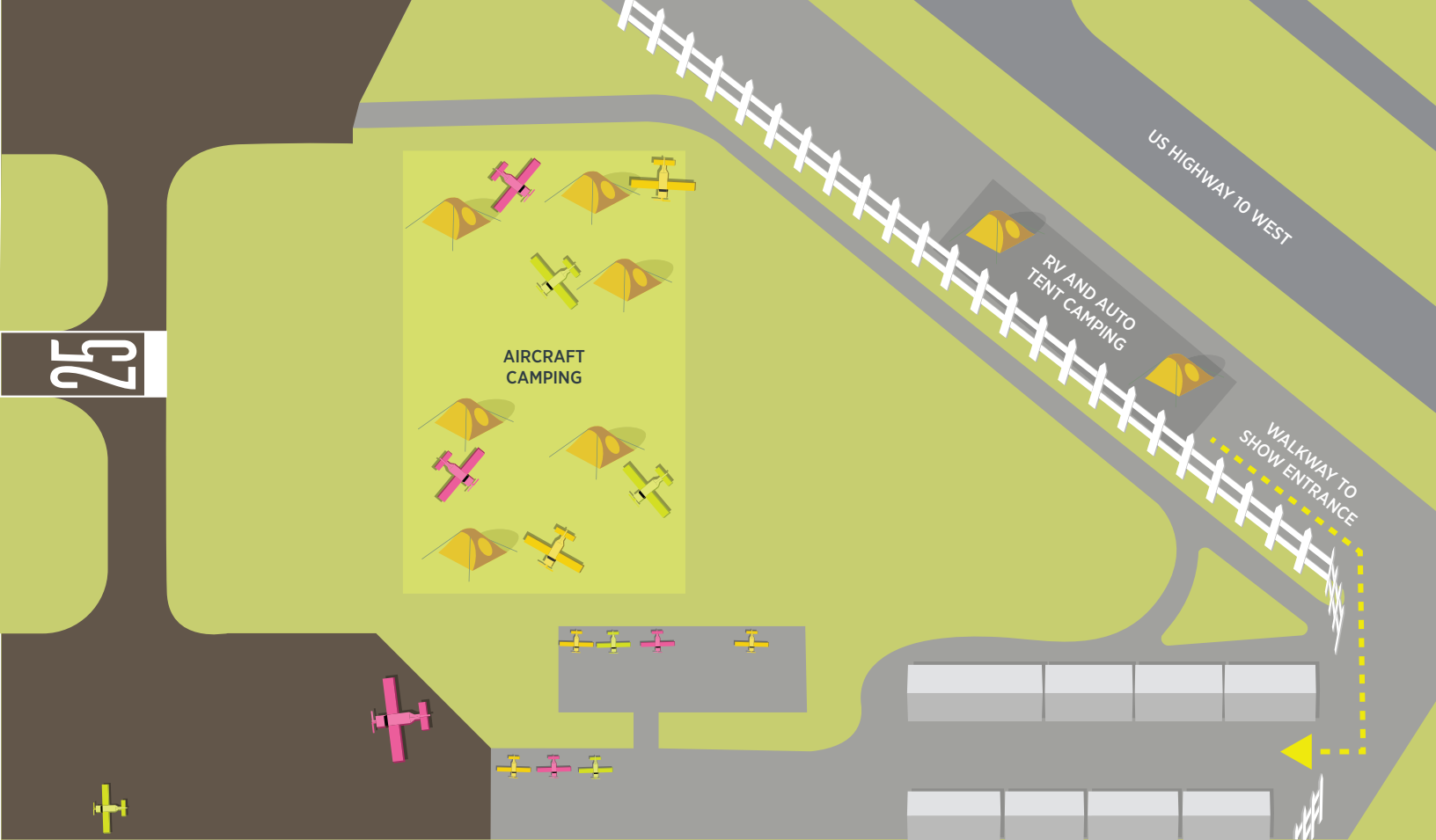

CAMPING AREA

RV camping will be available in the designated area shown above. Upon arrival, follow signs and volunteers to the camping area. Please check your map to be sure you are in the correct location along Aviation Way **BEFORE SETTING UP**, or you will be asked to relocate to the appropriate camping area. If unsure, please contact Erick Webb at the Tickets and Information Tent. Please park closely to allow as many others to camp as possible. After you register, you'll receive a "C" (for camping) to place on your dash or another easily visible area (not necessary to tape or attach to your vehicle or tent) to indicate you have paid for your camping spot. There will be a short walk to the show area, as indicated by the dashed yellow lines.

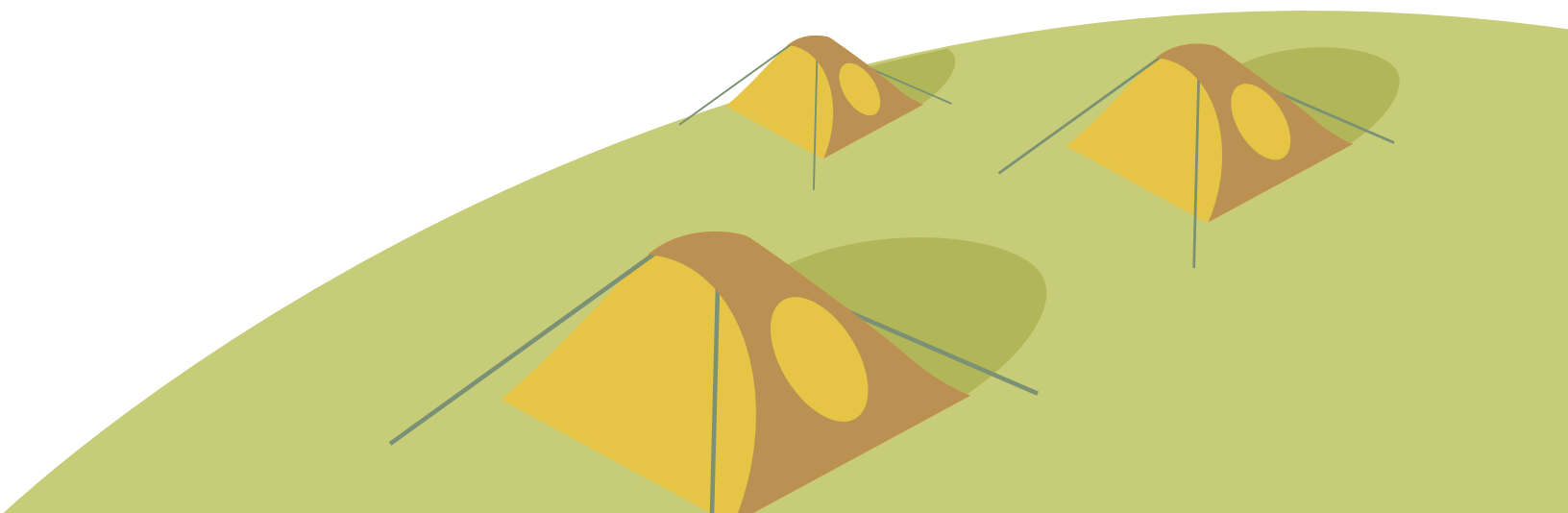

CAMPSITE RULES AND RESPONSIBILITIES

- **Pets are NOT permitted.**
- Alcoholic beverage consumption is prohibited in the camping area.
- Smoking is prohibited in the camping area.
- Coolers must remain secured at your campsite location.
- This is “primitive camping,” so please be prepared for your personal comfort.
 - Ice will not be available at the fly-in, so please plan to provide your own.
 - Portable restroom facilities and handwashing stations will be provided.
 - Shower facilities may be available with limited hot water capability, but will have limited access due to their location inside the airport fenced area.

FIRE SAFETY

Missoula International Airport strictly prohibits wood campfires and charcoal grills anywhere on airport property, including the Aircraft, RV, and Car/Tent camping areas. This includes camp stoves, propane burners, etc.

COURTESY

- Keep your campsite clean and your noise levels down.
- Please leave campsites the way you found them and place all waste in designated receptacles.
- Please do not hang laundry or other items.
- Please maintain appropriate clothing modesty.

A topographic map of the Missoula, Montana area, showing terrain contours, roads, and various landmarks. An orange rectangular box with a dotted pattern is overlaid on the map, containing the text "CLICK TO REGISTER FOR CAMPING" in bold, black, uppercase letters. The map includes labels for locations like Missoula, Lolo, and various peaks and mountains.

CLICK TO REGISTER FOR CAMPING